

Deluxe Bath Fans

Models 782 & 1001

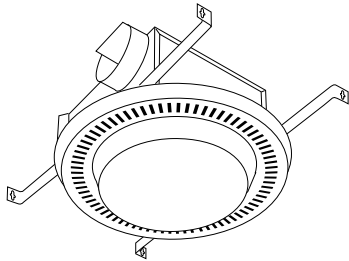

MODEL DESCRIPTION

These attractive ceiling units combine even, diffused lighting and quiet ventilation. A full 14 inches in diameter, this round design is pleasing in rooms where a traditionally shaped fixture is not aesthetically correct. These powerful ventilators draw mildew-building moisture from the room through a 4 inch round discharge. Model 1001 provides 100 CFM ventilation for bathrooms up to 95 sq. ft. and Model 782 provides 60 CFM ventilation for bathrooms up to 55 sq. ft. Both models feature low profile grills with either a glass lens (Model 1001) or Lexan® lens (Model 782).

FEATURES

- Low profile round grille with either glass (Model 1001) or Lexan® (Model 782) lens.
- 100 Watt Lamp Capacity (Lamp not included).
- Model 1001F uses 21 Watt 2D Fluorescent Lamp (Not included).
- 4" round duct adapter with integral back draft damper.
- Adjustable mounting brackets for easy installation between ceiling joists (16" O.C. or 24" O.C.)
- Plug-in light reflector assembly.
- Large, easily accessible outlet box.
- Low profile housing installs between 6" floor joists.

PERFORMANCE DATA

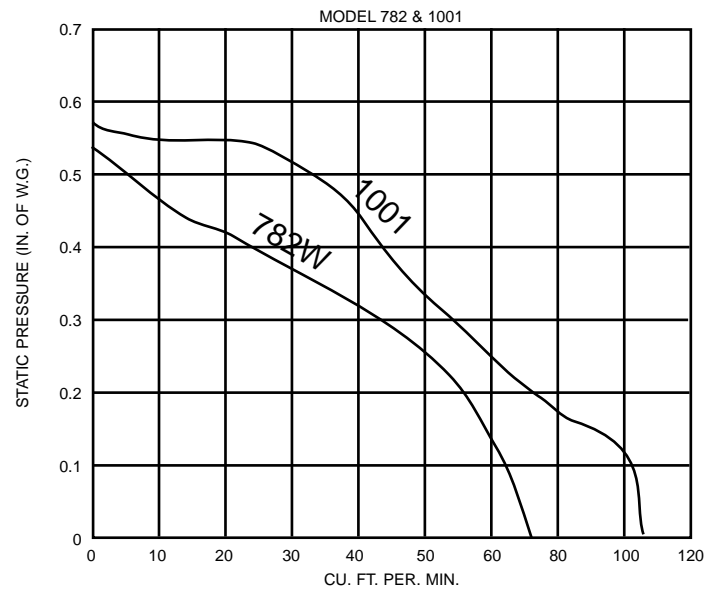

SUGGESTED SPECIFICATIONS

Bath Fans shall bear the HVI Tested Certified Seal and the UL label. Housing to be constructed of die formed, E.Z.C. plated, cold rolled steel. Housing shall have four integral slots in side wall for installation of mounting brackets. Two knockouts are provided on adjacent housing walls for access to the wiring compartment. Motor and lamp assembly shall be removable without removing the housing. Motor shall be direct drive and suitably grounded. A snap on plastic 4 inch duct adapter, with integral back draft damper, shall be provided. Grille shall be mounted to housing using two coil extension springs. Deluxe Bath Fans shall be from Marley Engineered Products, 470 Beauty Spot Road East, Bennettsville, SC 29512

SPECIFICATIONS

HVI CERTIFIED RATINGS



SQ. FT

MODEL	FINISH	DUCT SIZE	ROUGH-IN OPENING	AMPS	CFM	SONES	BATH	OTHER
782W	White	4"	12 ¹ / ₄ " Dia.	1.70	60	4.5	55	75
1001	White	4"	12 ¹ / ₄ " Dia	1.65	100	4.5	95	125
1001BR	Brass	4"	12 ¹ / ₄ " Dia	1.65	100	4.5	95	125
1001F	White	4"	12 ¹ / ₄ " Dia	1.0	100	4.5	95	125

REFERENCE	QTY.	REMARKS	Project
			Location
			Architect
			Engineer
			Contractor
			Submitted By
			Date

INSTALLATION INSTRUCTIONS

NEW HOME INSTALLATION

1. Remove the grille assembly from the carton and set it aside until needed. Remove reflector assembly from housing by loosening two mounting screws. Rotate and remove through keyhole slots. See Fig. 1.
2. Attach duct adapter to housing by first hooking mounting flange over edge of air discharge opening. Pivot duct adapter insuring (2) aligning tabs are inside opening and align (2) locking tabs with small rectangular holes. Press firmly into holes to lock. See Fig.2.

NOTE: The attachment of the duct adapter to the housing may be reinforced if desired, by installing a #8AB screw through the obround hole in the duct adapter and the small round hole in the housing.

3. Install housing between ceiling joists using one of the following options:
OPTION #1: Attach housing directly to ceiling joist using (4) screws or nails. See Fig 3. Flange on housing should drop below bottom of ceiling joist a distance equal to the thickness of the sheetrock and plaster.

OPTION #2: Insert (4) mounting brackets with angels pointing away from housing. In location between ceiling joists where housing will be located, drive (2) nails (4D or 6D) 1 1/8" from the bottom of the joist, 10" apart leaving 1/4" of nail projecting. Position one set of mounting brackets over nails and drop into place. Extend remaining mounting brackets to the adjacent joist and repeat nailing procedure. See Fig. 4. Finish driving nails and adjust housing between ceiling joist.

4. Run 120VAC, 60Hz power cables from wall switch/switches to appropriate knockout in housing. Use a BX or Romex connector.

NOTE: The knockout support may be reversed if desired, to open alternate knockout hole and cover unused hole. See Fig. 3. If both holes are to be used, simply remove knockout.

5. Remove outlet box cover by pulling downward while simultaneously pushing in on side of cover to release locking tab. Connect cables from wall switch/switches to receptacle wires using approved wire connectors. Connect ground wire to green wire in outlet box. These units can be wired so that vent and light function independently of each other, see Fig. 6, or wired so that when the light is on the vent is on, See Fig. 7. Replace outlet box cover insuring locking tab is engaged.

6. Insure that damper opens and closes freely. Install 4" round duct to discharge the fan to outside.

IMPORTANT: Be sure nothing obstructs the discharge of the vent. Take precautions to assure that insulation does not get into duct work or fan discharge opening.

7. Insert the lamp plug of reflector assembly into lamp receptacle on the outlet box. Align keyhole slots on reflector assembly mounting brackets over 2 screws on housing. Rotate assembly and tighten screws. (See Fig. 1). (Models 782 and 1001 only) Install a 100 watt (maximum), type A-19 light bulb. (Model 1001F only) Install a 21 watt 2-D 4-pin compact fluorescent lamp (F212D), not provided.

8. Squeeze grille mounting springs and insert into slots in housing. (See Fig. 1). NOTE: Snap plastic lens into grille on Model 782 if not assembled. Press griled firmly into place.

9. Check installation too insure that wiring has been installed properly and that no mechanical noise is evident which may be caused by loose components or vibration.

INSTALLATION IN EXISTING HOMES

1. Review the section: "New Home Installation" and follow instructions where applicable.
2. Drill a small hole in ceiling in proposed location, then locate this hole in the attic or crawl space.
3. In attic mark ceiling for cutout by using housing as a template. Using this line, make a cutout about 1/4" larger. (See Fig. 5).
4. Install duct adapter. (See Fig. 2).
5. Insert (4) mounting brackets with angels pointing away from housing. Place housing into hole and rest mounting brackets on sheetrock. Extend mounting brackets to joists. Drive a nail (4D or 6D) directly above the holes in the mounting brackets 1 1/8" from the bottom of joists, leaving 1/4" of the nail projecting. Position mounting brackets over nails and drop into place. Finish driving nails. Bottom of housing should be flush with ceiling. (See Fig. 5).
6. Remainder of the installation is the same as steps 4 thru 9 under "New Home Installation" above. Cracks between housing and ceiling may be plastered or caulked.

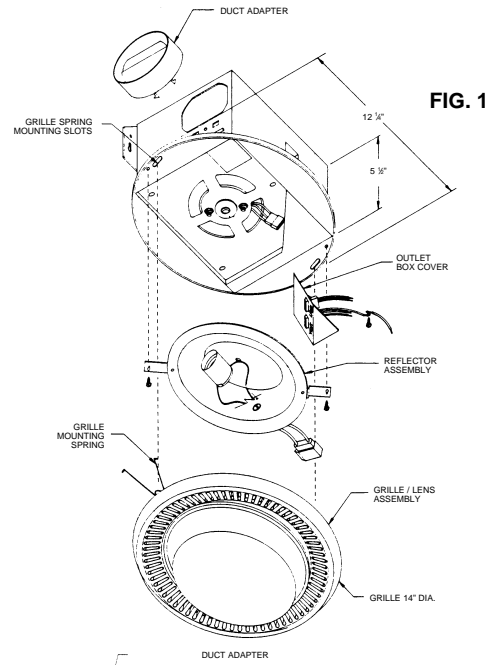

FIG. 1

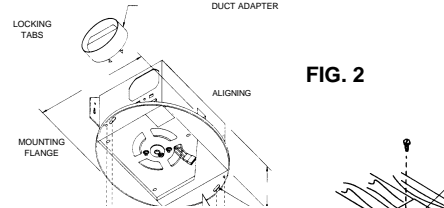

FIG. 2

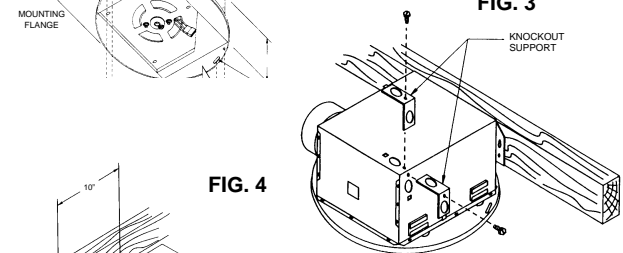

FIG. 3

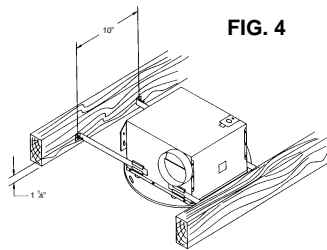

FIG. 4

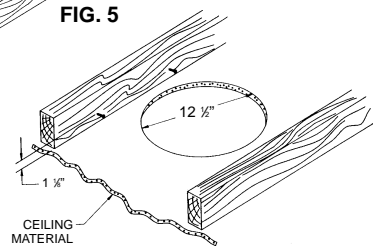

FIG. 5

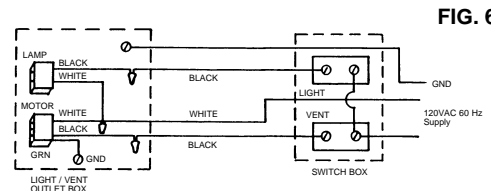

FIG. 6

TWO SWITCH CONTROL

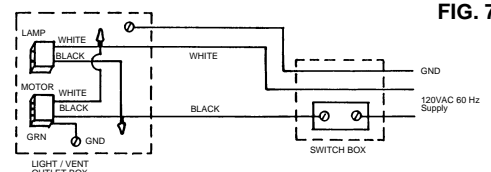

FIG. 7

ONE SWITCH CONTROL



470 Beauty Spot Road East,
 Bennettsville, SC 29512

For more info visit www.marleymep.com