

# Components



Strip and Ring

## SN & WS

3/4" Wide (SN)  
2-1/2" Wide (WS)



### Type SN

- 9-1/2 - 35-3/4" Lengths
- 100 - 600 Watts
- 120 and 240 Volt
- 7 - 11 W/In<sup>2</sup>

### Dimensions (type SN)

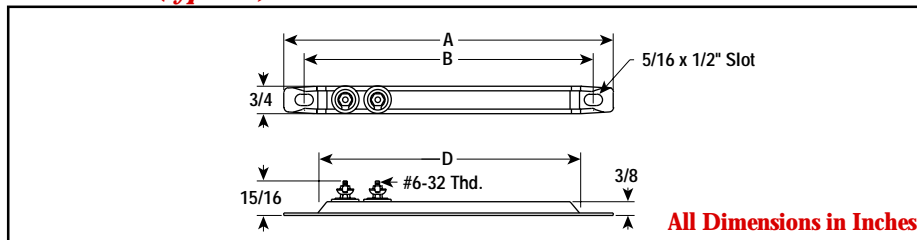

### Type WS

- 6-1/2 - 25-1/2" Lengths
- 400 - 1,500 Watts
- 120 and 240 Volt
- 8 - 25 W/In<sup>2</sup>

### Specifications and Ordering Information

| Dimensions (In.) |        |        | Watts | W/In <sup>2</sup> | Model   | Rust-Resisting Iron Sheath |        |       |        | Wt. (Lbs.) |  |
|------------------|--------|--------|-------|-------------------|---------|----------------------------|--------|-------|--------|------------|--|
| A                | B      | D      |       |                   |         | 120V                       |        | 240V  |        |            |  |
|                  |        |        |       |                   |         | Stock                      | PCN    | Stock | PCN    |            |  |
| 9-1/2            | 8-1/2  | 8      | 100   | 8                 | SN-910  | S                          | 132919 | —     | —      | 0.4        |  |
| 10-1/2           | 9-1/2  | 9      | 150   | 11                | SN-1015 | S                          | 132927 | —     | —      | 0.5        |  |
| 12               | 11     | 10-1/2 | 150   | 9                 | SN-1215 | S                          | 132935 | —     | —      | 0.6        |  |
| 15-1/4           | 14-1/4 | 13-3/4 | 200   | 8                 | SN-1520 | S                          | 132943 | S     | 132951 | 0.8        |  |
| 17-7/8           | 16-7/8 | 16-3/8 | 250   | 8                 | SN-1825 | S                          | 132960 | S     | 132978 | 0.9        |  |
| 23-3/4           | 22-3/4 | 22-1/4 | 300   | 7                 | SN-2430 | S                          | 132986 | S     | 132994 | 1          |  |
| 30-3/8           | 29-3/8 | 28-7/8 | 450   | 8                 | SN-3045 | S                          | 133006 | S     | 133014 | 1.3        |  |
| 35-3/4           | 34-3/4 | 34-1/4 | 600   | 9                 | SN-3660 | NS                         | 133022 | S     | 133030 | 1.5        |  |

**Stock Status:** S = stock AS = assembly stock NS = non-stock  
**To Order**—Specify model, PCN, watts, volts and quantity.

### Applications

Strip heaters are used for heat transfer by conduction or convection to heat liquids, air, gases and surfaces. See guidelines in the Strip Heater Overview section.

### Dimensions (type WS)

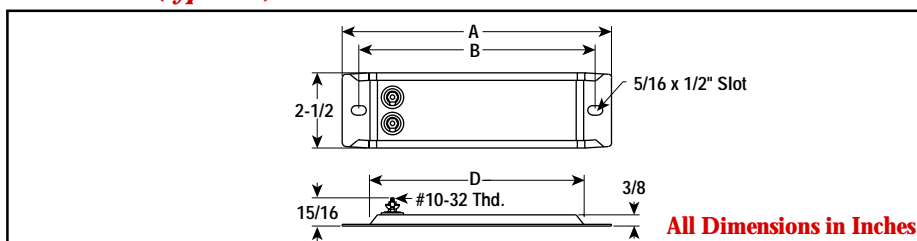

### Specifications and Ordering Information

| Dimensions (In.)                       |        |        | Watts | W/In <sup>2</sup> | Model   | 120V  |        | 240V  |        | Wt. (Lbs.) |
|--|--------|--------|-------|-------------------|---------|-------|--------|-------|--------|------------|
| A                                      | B      | D      |       |                   |         | Stock | PCN    | Stock | PCN    |            |
| <b>WS — Rust-Resisting Iron Sheath</b> |        |        |       |                   |         |       |        |       |        |            |
| 6-1/2                                  | 5-1/2  | 5      | 400   | 14                | WS-640  | S     | 132716 | S     | 132724 | 0.8        |
| 8-1/2                                  | 7-1/2  | 7      | 500   | 16                | WS-850  | S     | 132732 | S     | 132740 | 1          |
| 12                                     | 11     | 10-1/2 | 600   | 12                | WS-1260 | NS    | 144880 | NS    | 144899 | 1.4        |
| 15-1/4                                 | 14-1/4 | 13-3/4 | 750   | 11                | WS-1575 | S     | 132759 | S     | 132767 | 1.9        |
| 21                                     | 20     | 19-1/2 | 850   | 8                 | WS-2185 | NS    | 132775 | NS    | 132783 | 2.3        |
| 25-1/2                                 | 24-1/2 | 24     | 1,000 | 8                 | WS-2510 | S     | 132791 | S     | 132804 | 2.6        |
| <b>WS — Chrome Steel Sheath</b>        |        |        |       |                   |         |       |        |       |        |            |
| 6-1/2                                  | 5-1/2  | 5      | 500   | 25                | WS-605  | S     | 132812 | S     | 132820 | 0.8        |
| 8-1/2                                  | 7-1/2  | 7      | 600   | 19                | WS-806  | S     | 132839 | S     | 132847 | 1          |
| 12                                     | 11     | 10-1/2 | 800   | 16                | WS-1208 | NS    | 144872 | NS    | 144864 | 1.4        |
| 15-1/4                                 | 14-1/4 | 13-3/4 | 1,000 | 14                | WS-1501 | S     | 132855 | S     | 132863 | 1.9        |
| 21                                     | 20     | 19-1/2 | 1,250 | 12                | WS-2101 | NS    | 132871 | S     | 132880 | 2.3        |
| 25-1/2                                 | 24-1/2 | 24     | 1,500 | 12                | WS-2515 | NS    | 132898 | S     | 132900 | 2.6        |

**Stock Status:** S = stock AS = assembly stock NS = non-stock  
**To Order**—Specify model, PCN, watts, volts and quantity.

**Note** — If terminal housing is required with a type WS strip heater, use a type SE-AC-1 mounted sideways. Ceramic post terminal insulators can also be used. (See Strip Heater Overview Section.)